

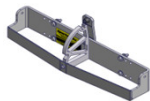

Bike Rack Accessories	Advertising Frame	Deployment Indicator	Kwikstand	Torsion Springs	Turn Signal Kit	Quick-Release Pivot Bolts
Specifications						
Description	13" x 32" or 14" x 44" bus-front advertising panel	Magnetic sensor/dash light informs driver when rack is deployed	Portable stand that supports rack for demos and trainings	Springs offset and reduce lifting weight of rack	Turn signals that attach to rack for increased safety and visibility	Hand knob and nylock wing nut allow fast tool-less removal of bike rack from pivot plate
Construction	Anodized Aluminum	N/A	Mild Steel	Stainless Steel	N/A	Stainless steel, zinc and brass
Available Finishes	Anti-Glare	N/A	Powder Coat	Powder Coat	N/A	N/A
Colors	Silver	N/A	Various	Black	N/A	Silver
Rack Compatibility	DL2, DL2 NP, DL3, V2, V3	DL2, DL2 NP, DL3, V2, V3	DL2, DL2 NP, DL3, V2, V3	DL2, DL2 NP, DL3, V2, V3	Trilogy (DL3)	DL2, DL2 NP, DL3, V2, V3
Options	Pre-cut media inserts available. Torsion springs recommended.	N/A	N/A	Available in single (1) and double (2) spring kits	Available as OEM or after-market equipment	N/A



Bike Rack Hardware	Apex Pivot Plate	Standard Pivot Plate	NP Pivot Plate	Ten Second Bracket	Stand Off Bracket	Universal C-Bracket
Specifications						
Description	Secures bike rack to brackets on Apex 3 rack	Secures bike rack to brackets on standard width racks	Secures bike rack to brackets on narrow profile racks	Allows tool-free installation in 10 seconds or less	Bracket attaches through holes drilled in bumper	Bracket attaches around bumper to alleviate drilling
Width	20"	26"	16 7/8"	26"	N/A	N/A
Weight (lbs)	19.9	19.3	16.5	38.7	12	13
Rack Compatibility	Apex 3	DL2, DL3, V2, V3	DL2 NP	DL2, DL3, V2, V3	N/A	N/A
Installation	N/A	N/A	N/A	Available for OEM or after-market installation. Romeo Rim HELP Bumper required.	Removal of bumper not required	Removal of bumper required