

Required Tools

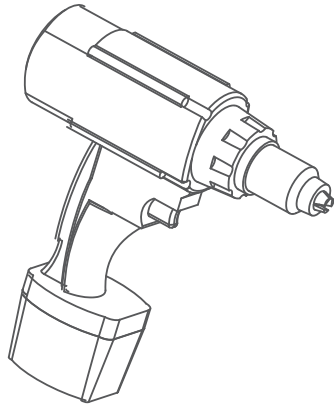

Portable Hammer Drill



Carbide Tip 3/8" Concrete Drill



Carbide Tip 1/4" Concrete Pilot Drill

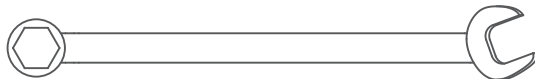

Wrench, 9/16"

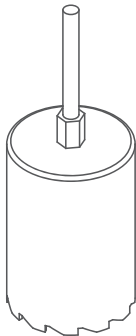

Core Drill (in-ground mount)

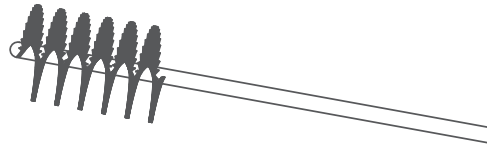

Wire Brush (optional)

Available Fasteners



Wedge Anchor

Concrete Wedge Anchors
3/8" Diameter x 3" Length
Steel Zinc Plate

Washer
3/8" ID x 0.xx" OD x 0.060"
Thickness

Nut, Hex Head
3/8"-16
Steel Zinc Plated



Drive Anchor

Concrete Drive Anchors
3/8" Diameter x 3.5"
Steel Zinc Plate

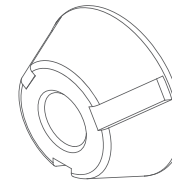

Tamper Resistant Nut

Tamper Resistant Nut
Tri-Groove, 3/8"-16

Surface Mount – Wedge Anchor

1. Mark Holes

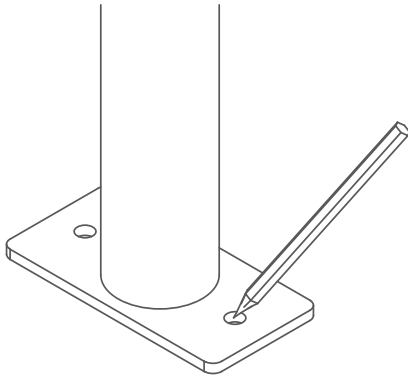

Set your bike rack in the location where you wish to install it. Use a pencil or center punch to mark hole locations on concrete using the bike rack feet as templates.

2. Drill Holes.

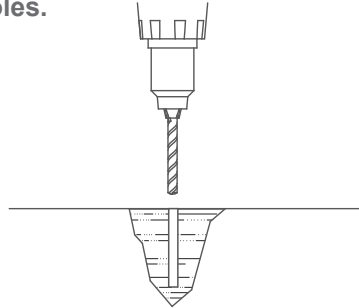

For best results, start with the 1/4" drill bit, and hammer drill to create a pilot hole on your installation marks.

Use a nominal size drill bit, for 3/8" Wedge Anchor use a carbide tipped 3/8" drill bit that follows ANSI Standard B212.15 to drill 3.5" deep holes. The required minimum depth is specified by the anchor manufacturer.

Drilling deeper than the required depth will allow room for the hole debris to collect without interfering with concrete anchor installation.

3. Clean hole.

Clean the drilled hole with a wire brush and/or compressed air.

4. Set Rack in Place.

Set rack so that holes in the mounting feet align with the holes drilled in Step 3. Insert washer onto anchor. Thread the nut onto the anchor such that the top surface of the nut is flush with the anchor stud to protect the anchor threads during the subsequent installation.

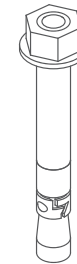

Anchor assembly with nut installed flush to top surface of anchor stud.

5. Level Rack (If Needed).

If the concrete surface is uneven use washers between the bike rack mounting plate and the concrete to level the rack.

6. Hammer Anchors

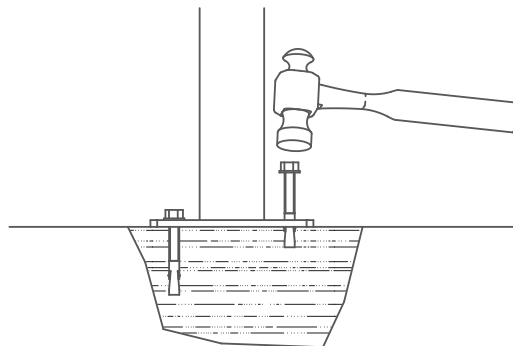

Line up bike rack with holes, insert anchor through bike rack mounting plate hole. Drive the anchor through with a suitable hammer until the washer and nut contact the bike rack mounting plate.

7. Tighten Nuts

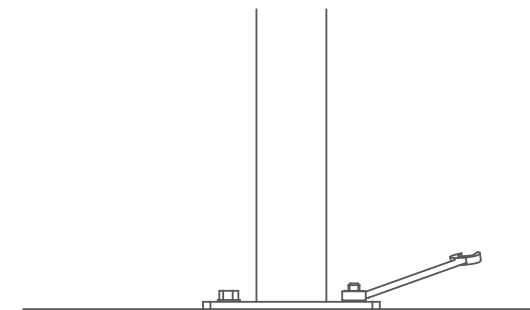

When all anchors are installed, torque nuts to 20-30 ft-lbs (for 3/8" anchor).

Surface Mount – Drive Anchor

1. Mark Holes

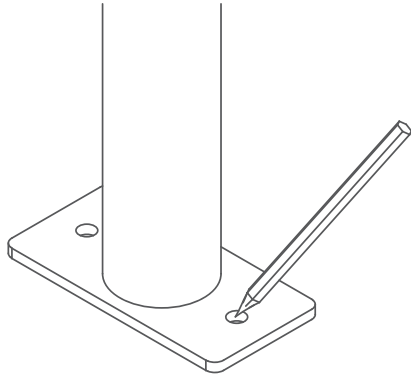

Set your bike rack in the location where you wish to install it. Use a pencil or center punch to mark hole locations on concrete using the bike rack feet as templates.

2. Drill Holes

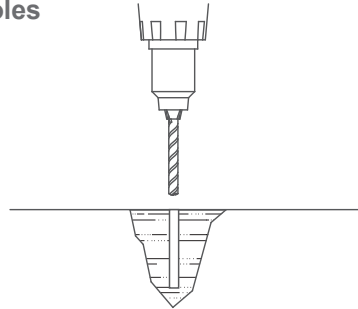

For best results, start with the 1/4" drill bit, and hammer drill to create a pilot hole on your installation marks.

Use a carbide tipped drill bit that follows ANSI Standard B212.15 to drill 4" deep holes. The required minimum depth is specified by the anchor manufacturer.

Drilling deeper than the required depth will allow room for the hole debris to collect without interfering with concrete anchor installation.

3. Clean hole

Clean the drilled hole with a wire brush and/or compressed air.

4. Set Rack in Place

Set rack so that holes in the mounting feet align with the holes drilled in Step 3.

5. Level Rack (If Needed)

If the concrete surface is uneven use washers between the bike rack mounting plate and the concrete to level the rack.

6. Drive Anchor

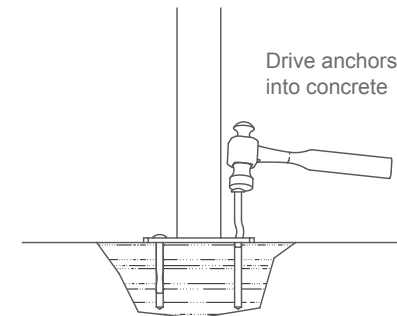

Insert anchor through bike rack mounting plate hole. Line the anchor up vertically with the hole you drilled in concrete in step 3. Drive in the anchor with a suitable hammer until the washer and nut contact the bike rack feet.

Embed in Existing Concrete

1. Mark Hole Locations

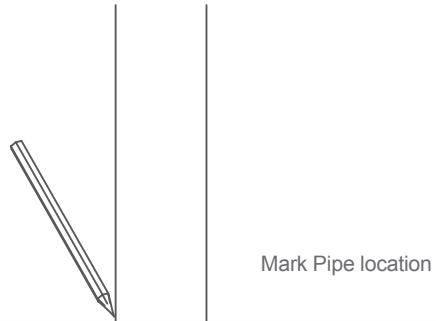

Mark location of rack legs on existing concrete.

2. Core hole(s) in concrete.

For 2" Schedule 40 Pipe a 4" diameter hole is recommended.

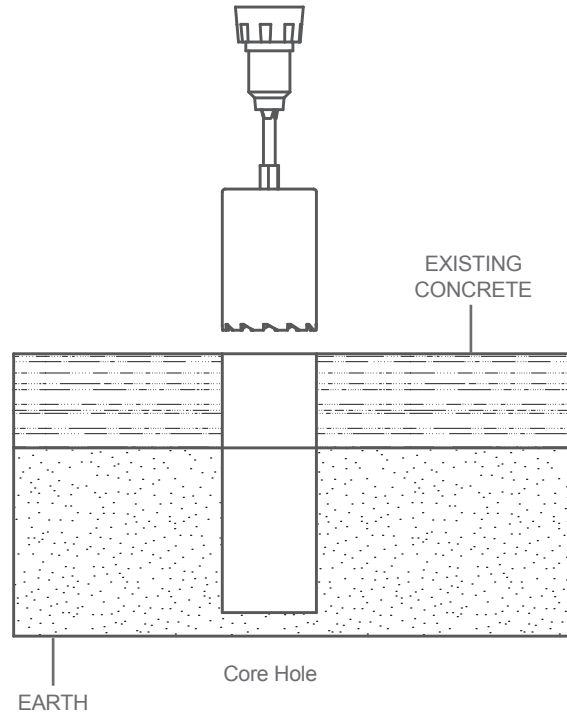

3. Place leg(s) into hole(s) and fill holes with epoxy grout.

Clean the drilled hole with a wire brush and/or compressed air.

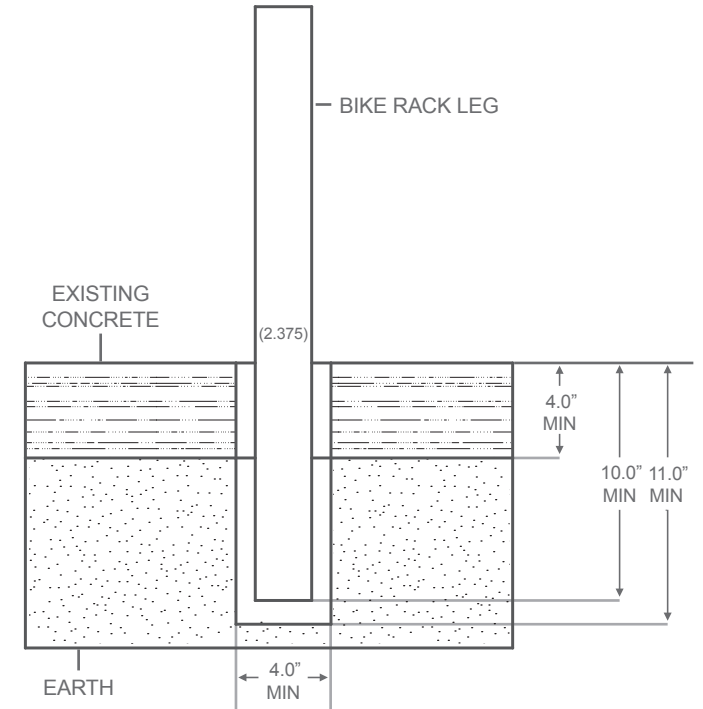

Embed bike rack into concrete using the above guidelines

4. Hold the rack in position until the grout is set.

Surface Mount – Multi Bike with Channels

1. Assemble U-Racks onto channels using supplied fasteners as shown.

Install fasteners loosely, straighten rails and torque fasteners.

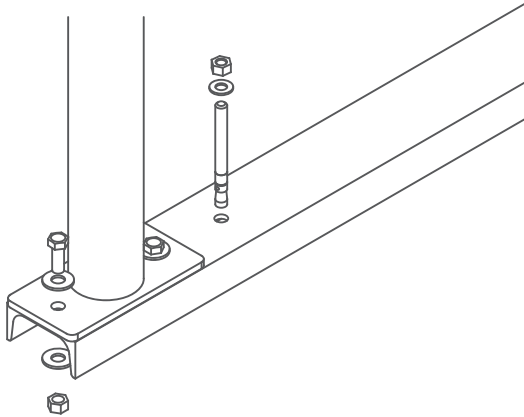

2. Mark the location where holes will be drilled on the concrete using the channels as templates.

Remove the rack.

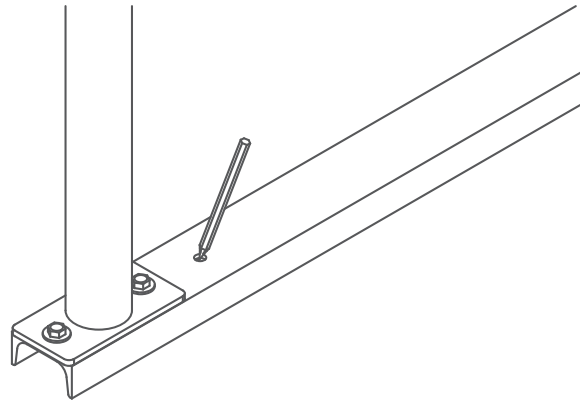

3. For 3/8" Anchor, use a carbide tipped 3/8" drill bit that follows ANSI Standard B212.15 to drill 3" deep holes.

For best results, start with the 1/4" drill bit, and hammer drill to create a pilot hole on your installation marks.

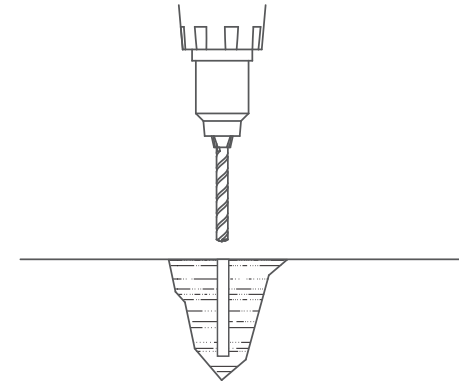

4. Clean the drilled hole with a wire brush and/or compressed air.

5. Set rack so that holes in the channel align with the holes drilled in Step 3.

Insert washer onto anchor. Thread the nut onto the anchor such that the top surface of the nut is flush with the anchor stud to protect the anchor threads during the subsequent installation.

6. Insert anchor through bike rack mounting plate hole.

Line the anchor up vertically with the hole you drilled in concrete in step 3. Drive in the anchor with a suitable hammer through the channel and into the hole until the washer and nut contact the channel.

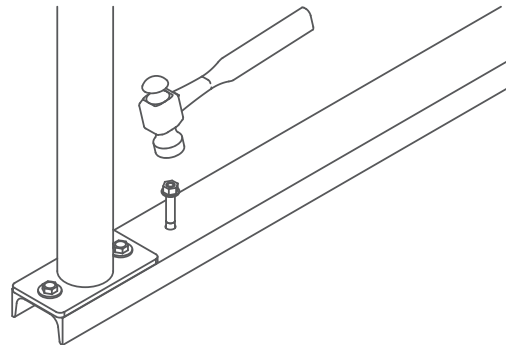

7. When all anchors are installed, torque nuts to 20-30 ft-lbs (for 3/8" anchor).

